

JOBOLT – VISU-LOK TOOLS

RIGHT ANGLE MODEL 7440

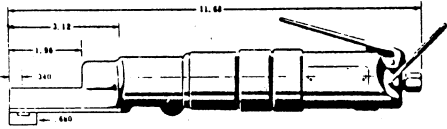

CAP. 5/32-1/4

7440-REC (REBUILT)

OPERATING PRESSURE 90 PSIA (MIN.)
 TORQUE OUTPUT 108 IN. LB. at 90 PSIA
 STALL TORQUE 10 FT. LB. (MIN.)
 MOTOR SPEED 500 RPM
 AIR CONSUMPTION AT
 FREE SPEED 18 CFM (MAX.)
 HORSEPOWER RATING 0.33
 WEIGHT 3½ LBS.
 WORK SPACE NEEDED PORTABLE

DIA.	VISU-LOK SERIES	ADAPTER ASSEMBLY
5/32	PLT110-5	PW465
	PLT210-5	PW465P
	PLT130-5	PW465A
	PLT1058-5	PW465T
3/16	PLT110-6	PW400
	PLT210-6	PW400P
	PLT130-6	PW400A
	PLT1058-6	PW400T
1/4	PLT110-8	PW460
	PLT210-8	PW460P
	PLT130-8	PW460A
	PLT1058-8	PW460T

PISTOL MODEL S540MTD

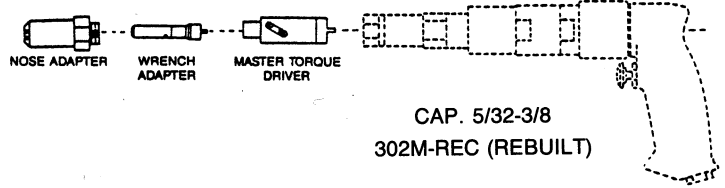

CAP. 5/32-3/8
 302M-REC (REBUILT)

OPERATING PRESSURE 90 PSIA (MIN.)
 TORQUE OUTPUT 190 IN. LB. at 90 PSIA
 STALL TORQUE 17.9 FT. LB. (MIN.)
 MOTOR SPEED 450 RPM
 AIR CONSUMPTION AT
 FREE SPEED 22 CFM (MAX.)
 HORSEPOWER RATING 0.43
 WEIGHT 3 LB.
 WORK SPACE NEEDED PORTABLE

DIA.	VISU-LOK SERIES	ADAPTER ASSEMBLY
5/32	PLT110-5	TD185
	PLT210-5	TD185P
	PLT130-5	TD185A
	PLT1058-5	TD185T
3/16	PLT110-6	TD200
	PLT210-6	TD200P
	PLT130-6	TD200A
	PLT1058-6	TD200T
1/4	PLT110-8	TD260
	PLT210-8	TD260P
	PLT130-8	TD260A
	PLT1058-8	TD260T
5/16	PLT110-10	TD312
	PLT210-10	TD312P
	PLT1058-10	TD312T
3/8	PLT110-12	PT375
	PLT210-12	PT375P
	PLT1058-12	PT375T

ADAPTER ASSEMBLIES

SPECIFY SIZE

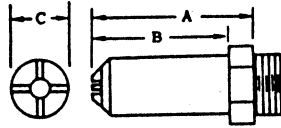

FLUSH & REDUCED FLUSH "T" SERIES

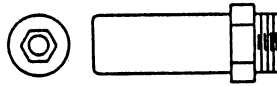

PROTRUDING SERIES

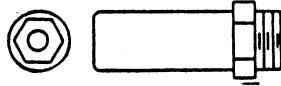

MILLABLE SERIES

VISU-LOK® RATCHET HAND TOOL COMPLETE ASSEMBLIES

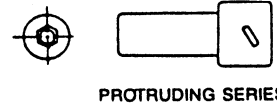
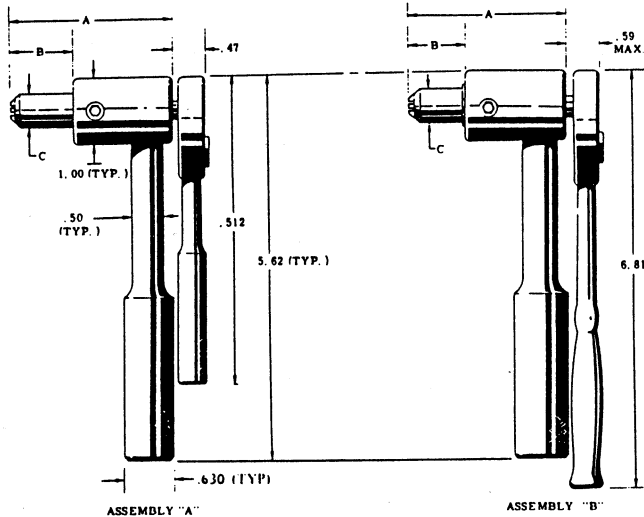

PROTRUDING SERIES



FLUSH & REDUCED FLUSH "T" SERIES

DIA.	VISU-LOK SERIES	COMPLETE ASSEMBLY	A ± .015	B ± .015	C ± .010
5/32	PLT110-5	HWF165	2.330	.890	.500
	PLT210-5	HWP165	2.377	.937	.453
	PLT130-5	HWA165	2.357	.917	.453
	PLT1058-5	HWT165	2.325	.885	.500
3/16	PLT110-6	HWF200	2.332	.892	.500
	PLT210-6	HWP200	2.388	.948	.453
	PLT130-6	HWA200	2.377	.937	.500
	PLT1058-6	HWT200	2.327	.887	.500

DIA.	VISU-LOK SERIES	COMPLETE ASSEMBLY	A ± .015	B ± .015	C ± .010
1/4	PLT110-8	HWF260	2.335	.895	.500
	PLT210-8	HWP260	2.405	.965	.500
	PLT130-8	HWA260	2.390	.950	.625
	PLT1058-8	HWT260	2.330	.890	.500
5/16	PLT110-10	HWF312	2.355	.915	.562
	PLT210-10	HWP312	2.445	1.005	.625
	PLT1058-10	HWT312	2.350	.910	.562
3/8	PLT110-12	HWF375	2.370	.925	.687
	PLT210-12	HWP375	2.480	1.020	.687
	PLT1058-12	HWT375	2.385	.920	.687

NOTES:
 ASSEMBLY "A" COMPLETE TOOLS
 INCORPORATE HW200 DRIVER

ASSEMBLY "B" COMPLETE TOOLS
 INCORPORATE HW300 DRIVER