

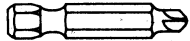

SCREWDRIVER ACCESSORIES

TORQ-SET®
(PHILLIPS SCREW CO.)

1/4" HEX SHANK

#170 SERIES  **#212 SERIES** 

Overall Length 1-1/4"

Screw Size	Power Bit Part Number	Insert Bit Part Number
0	TS170-0	TS 212-0
1	TS170-1	TS 212-1
2	TS170-2	TS 212-2
3	TS170-3	TS 212-3
4	TS170-4	TS 212-4
5	TS170-5	TS 212-5
6	TS170-6	TS 212-6
8	TS170-8	TS 212-8
10	TS170-10	TS 212-10
1/4	TS170-1/4B	TS 212-1/4

TRIWING®

1/4" HEX SHANK

Overall Length 1-1/4"

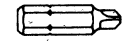
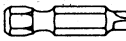
"TWD" SERIES  **"TW" SERIES** 

Screw Size				
Recess Size	Tension Head	Shear Head	Insert Bit Part Number	Power Bit Part Number
0	0-80	-	TWD-0	TW-0
1	2-56	4-40	TWD-1	TW-1
2	4-40	6-32	TWD-2	TW-2
3	6-32	8-32	TWD-3	TW-3
4	8-32	10-32	TWD-4	TW-4
5	10-32	1/4-28	TWD-5	TW-5
6	1/4	5/16	TWD-6	TW-B6

3/8" FEMALE SQUARE DRIVE

For 1/4" Hex Inserts



1-1/2 OAL

HI-TORQUE

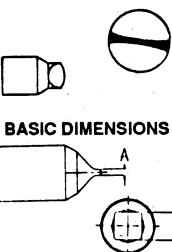

Driver Part Number	Nom. Screw Size	A (Ref)	B (Ref)
HTS-0	0, 1, 2	.029	1/4
HTS-1	3, 4, 5, 6	.049	1/4
HTS-2	8	.059	1/4
HTS-3	10	.059	1/4
HTS-4	1/4	.073	1/4
HTS-5	5/16	.079	3/8
HTS-6	3/8	.095	3/8
HTS-7	7/16	.112	1/2
HTS-8	1/2	.142	1/2



#838

ECONOMY MODELS

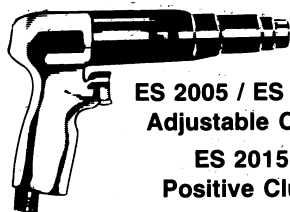

ES 2005 / ES 2009 -
Adjustable Clutch

ES 2015 -
Positive Clutch



AP 800 - Adjustable Clutch

MODEL	FREE SPEED	SCREW SIZE
ES2005	1800 RPM	#12
ES2009	800 RPM	1/4"
ES2015	1800 RPM	#12
AP 800	1800 RPM	#12

1/4" HEX SHANK

PHILLIPS

1" OAL

OAL	Point Size	Power Bit Part No.	Insert Bit Part No.
1-15/16"	1	491	221
1-15/16"	2	492	222
1-15/16"	3	493	223
2-3/4"	1	491A	
2-3/4"	2	492A	
2-3/4"	3	493A	
3-1/2"	2	492B	
3-1/2"	3	493B	

1/4" HEX SHANK POWER BITS

Slotted	1-15/16" OAL	2-3/4" OAL	3" OAL
Screw Size	Part No.	Part No.	Part No.
1F-2R	320-000	326-000	323-000
2F-3R	320-00	326-00	323-00
3F-4R	320-0	326-0	323-0
4F-5R	320-1	326-1	323-1
5F-6R	320-2	326-2	323-2
6F-7R	320-3	326-3	323-3
8F-10R	320-4	326-4	323-4
10F-12R	320-5	326-5	323-5
12F-14R	320-6	326-6	323-6

1/4" HEX INSERT BITS

1" OAL

Screw Size	Part No.
1F-2R	445-1
2F-3R	445-2
3F-4R	445-3



TOOL BALANCERS

#40 2-5 LBS. #22 5-10 LBS.

magnetic bit holder

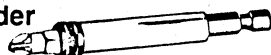

M 10A 1/4" Hex Shank 2-7/8" Long
1/4" Hex Opening

No. 185 For Socket Head
Screws (Allen Type)
Specify Size: 1/16"-3/8"

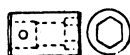

1/4" Square Drive Sockets
Specify Size for Hex Nuts

No. 100 3/16" - 1/2"

No. 0-024 Socket Extension
1/4" Hex x 1/4" Square

